



ACCENDO
LIGHTING

Hazardous Environment

"Multi-Purpose" LED Area Light

Petroleum production, refineries, storage, and transportation facilities. Utility power generation plants and sub-stations. Mining operations and processing. Off shore oil platforms. Food processing and distilling. Paint and chemical production/storage. Wastewater treatment plants. Aerospace and military facilities (hazardous locations). Flour/grain and other fine dust particulate processes.

Project Name:	Type:
Location:	
Model Number:	
Approved By:	Date:
Notes:	



FEATURES:

- Die Cast "copper free" aluminum housing
- IK rated for vibration applications
- 140 LPW CREE LED Chips >70CRI
- Suitable for wall or ceiling mount installations. See "Options" for all available mounting configurations and accessories.
- Up to 60% reduced energy consumption over traditional HID and fluorescent sources.
- Ambient operating temperatures -40-60°C
- L70 >150,000 Hours
- Standard 5 Year Manufacturer's Warranty

LISTINGS:

- Class I, Division 1, Groups C,D
- Class I, Division 2, Groups A,B,C,D
- Class II, Division 1, Groups E,F,G
- Class II, Division 2, Groups E,F,G
- Class III
- UL 1598 Wet location
- UL 1589A Marine Outside Type
- UL844
- CSA C22.2 No. 137/No. 250.0
- NEMA 4X
- IP66
- IECEX
- ATEX

Dimensions:

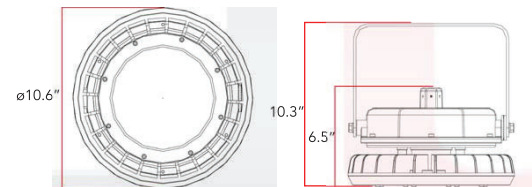

Ordering Information:

Ordering Example: AL-LED-EXP-040-B-40-Z40-PS-WG

Series	Wattage/Lumens	Housing	Kelvin/CCT	Beam Angle	Mounting	Options
AL-LED-EXP	020 - 2800lms	B	40 - 4000K	Z40 - 40°	PS - Pole Stachion PS25° - 25° Pole Stachion CB - Ceiling Bracket P - Pendant Pole P12° - 12° Pendant Pole ARM - Wall Arm	WG - Wire Guard DR - Dome Reflector AR - Angle Reflector
	040 - 5600lms		50 - 5000K	Z60 - 60°		
	060 - 8400lms		57 - 5700K	Z90 - 90°		
	080 - 11200lms			Z120 - 120°		
	100 - 14000lms					
	120 - 16800lms					
	150 - 21000lms					
	200 - 28000lms					

Performance Data

Wattage	Lumens	LPW	CRI
20	2800	140	70
40	5600	140	70
60	8400	140	70
80	11200	140	70
100	14000	140	70
120	16800	140	70
150	21000	140	70
200	28000	140	70

Powered By



Distributions/Optics

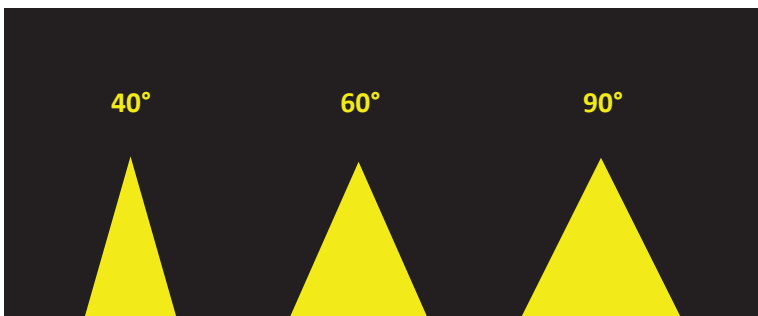

Consult factory for current IES photometric files

Mounting Accessories/Options

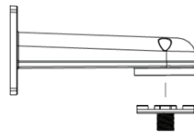

Wall Bracket (Suffix-WB)

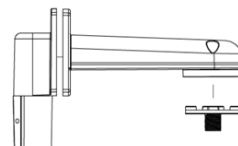

Pole Mount (Suffix-PM)

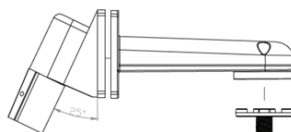

Angle Pole Mount (Suffix-APM)

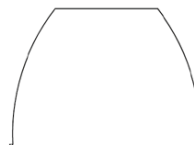

Dome Reflector (Suffix-DR)

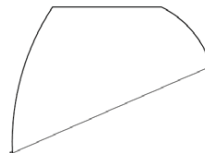

Angle Dome Reflector (Suffix-ADR)

Ceiling Bracket



Ex-Box

+
Pendant Mount (Suffix P)

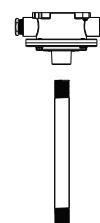

AnglePendant Mount (Suffix AP)

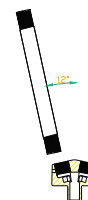

Note: Consult factory for complete list of mounting accessories.