



ACCENDO
LIGHTING

Hazardous Environment

"Multi-Purpose" LED Area Light

Typical Applications:

Petroleum production, refineries, storage, and transportation facilities. Utility power generation plants and sub-stations. Mining operations and processing. Off shore oil platforms. Food processing and distilling. Paint and chemical production/storage. Wastewater treatment plants. Aerospace and military facilities (hazardous locations). Flour/grain and other fine dust particulate processes.

Project Name:	Type:
Location:	
Model Number:	
Approved By:	Date:
Notes:	



FEATURES:

- Die Cast "copper free" aluminum housing
- IK rated for vibration applications
- 140 LPW CREE LED Chips >70CRI
- Suitable for wall or ceiling mount installations. See "Options" for all available mounting configurations and accessories.
- Up to 60% reduced energy consumption over traditional HID and fluorescent sources.
- Ambient operating temperatures -40-60°C
- L70 >150,000 Hours
- Standard 5 Year Manufacturer's Warranty

LISTINGS:

- Class I, Division 1, Groups C,D
- Class I, Division 2, Groups A,B,C,D
- Class II, Division 1, Groups E,F,G
- Class II, Division 2, Groups E,F,G
- Class III
- UL 1598 Wet location
- UL 1589A Marine Outside Type
- UL844
- CSA C22.2 No. 137/No. 250.0
- NEMA 4X
- IP66
- IECEX
- ATEX

Dimensions:

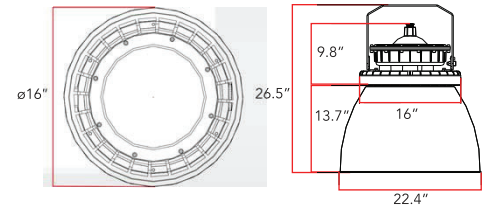

Ordering Information:

Ordering Example: AL-LED-EXP-060-C-40-Z60-ARM

Series	Wattage/Lumens	Housing	Kelvin/CCT	Beam Angle	Mounting	Options
AL-LED-EXP	060 - 8400lms 080 - 11200lms 100 - 14000lms 150 - 21000lms	C	40 - 4000K 50 - 5000K 57 - 5700K	Z40 - 40° Z60 - 60° Z90 - 90° Z120 - 120°	PM - Pole Mount APM - 25° Pole Mount CB - Ceiling Bracket P - Pendant Pole APM - 12° Pendant Pole WB - Wall Bracket TR - Trunion Bracket	DR - Dome Reflector AR - Angle Reflector

Performance Data

Wattage	Lumens	LPW	CRI
60	8400	140	70
80	11200	140	70
100	14000	140	70
150	21000	140	70

Powered By



Distributions/Optics

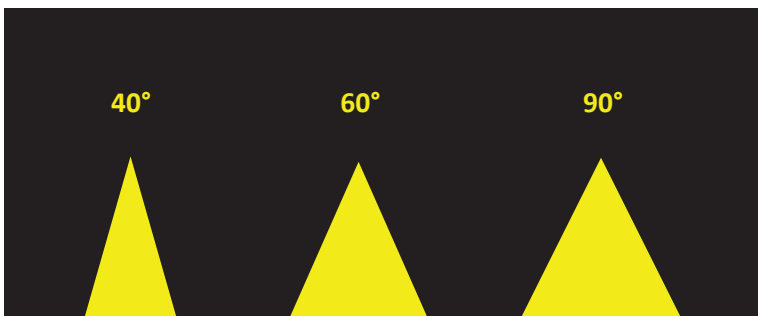

Consult factory for current IES photometric files

Mounting Accessories/Options

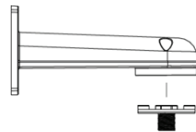

Wall Bracket (Suffix-WB)

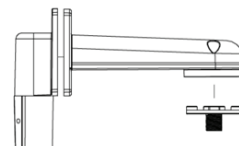

Pole Mount (Suffix-PM)

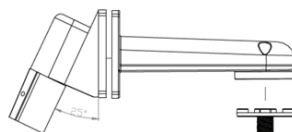

Angle Pole Mount (Suffix-APM)

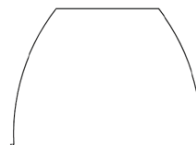

Dome Reflector (Suffix-DR)

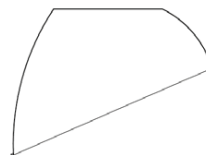

Angle Dome Reflector (Suffix-ADR)

Ceiling Bracket



Trunion Bracket

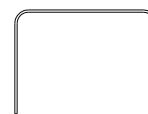

Ex-Box

+
Pendant Mount (Suffix P)

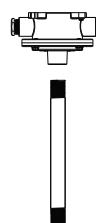

AnglePendant Mount (Suffix AP)

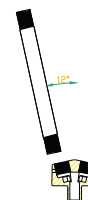

Note: Consult factory for complete list of mounting accessories.