



General Description:

The multi-function area lighting fixture is a versatile and innovative solution designed to meet a wide range of lighting needs. It features the first selectable light distribution design available in the lighting market, offering unmatched flexibility for various applications. It also features innovative selectable light distribution technology, and the type III and V light distribution can be effortlessly adjusted using a lighting distribution switch. With its adjustable settings and straightforward installation process, this fixture is especially convenient for contractors working on-site. With five different mounting options such as pole, flexible arm, wall, slip-fitter, and trunnion, the multi-purpose area light can be easily transformed from area light to floodlight or wall-pack configurations. The ease of setup not only simplifies the installation process but also significantly reduces both time and labor costs, making it an efficient and cost-effective choice for any project.

FEATURES

- Adjustable lumen packages from 15,000 to 40,000L
- CCT/Lumen/Light Distribution Adjustability
- Sleek ultra-slim housing for a modern aesthetic.
- Field Distribution Selectable: Type III, Type V Polycarbonate Lens

CONSTRUCTION

- Detachable driver structure for easy maintenance.
- Openable wiring cavity design for easy access.
- Die-cast all aluminum Housing.

ELECTRICAL

- Surge Protection: 10KV Standard, 20KV Optional.
- Operating Temperature: -40°C to +50°C (-40°F to +122°F)

CONTROLS

- Motion Sensor: PIR Sensor or Wattstopper Sensor

MOUNTING

- Multi-mounting accessories.

WARRANTY

- Backed by Accendo's Limited 5-year warranty.

Ordering Information

Ordering Example: AL06-24L-3/4/5k-OPS-BZ-ARM-ECOL

	LUMENS	CCT	Lens/Optics	Finish	Mounting	Options	
AL06	15/21/24L 30/35/40L	3/4/5K CCT Selectable	OPS Distribution Selectable	BZ Bronze	ARM ARM 4" and 5" sq/rd. ARMADJ Up/Down Adjustable Arm SF Slipfiter WALL Wall Mount YOKE Yoke Mount	N3 3Pin NEMA Socket N7 7Pin NEMA Socket PIR PIR Motion Sensor ZHAGA ZHAGA Sensor	ECOL

Measurements:

15/21/24L

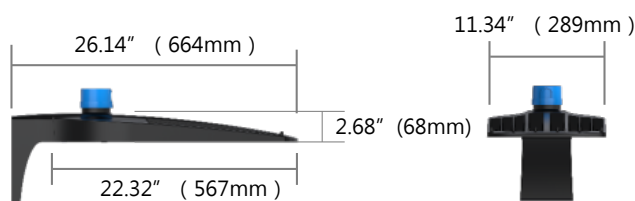

30/35/40L

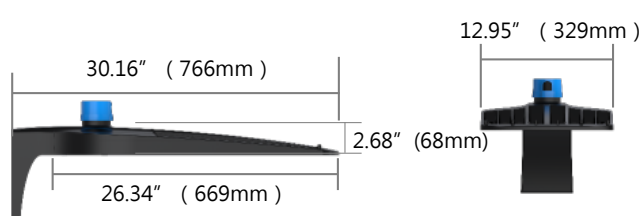

Additional:

Distribution Selectable:

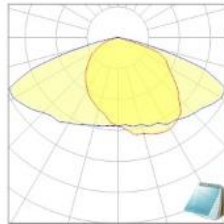

T3

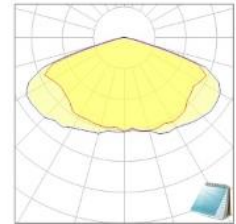

T5

Installation:

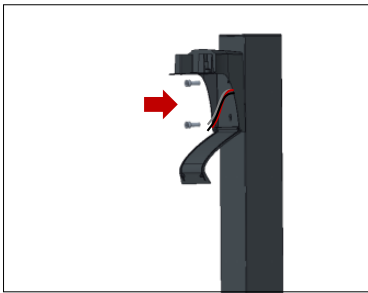

1. Lock mounting bracket on pole

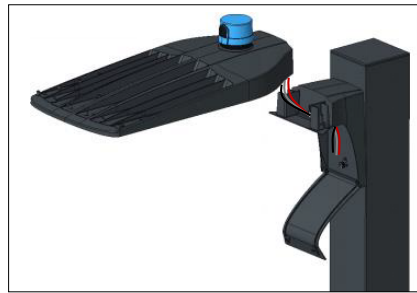

2. Threaded wires into wiring cavity

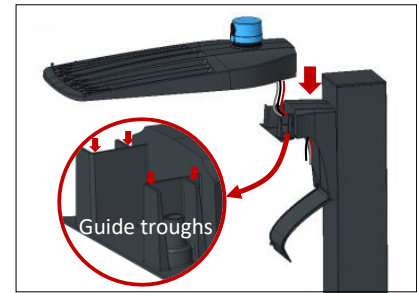

3. Insert the light into mounting bracket through the formed guide troughs, leaves your hands free

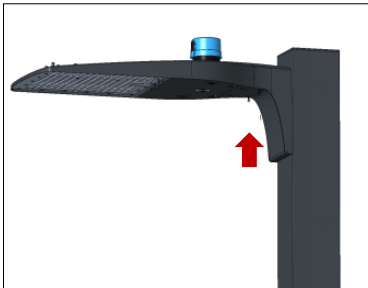

6. Close and screw the wiring cavity, then complete.

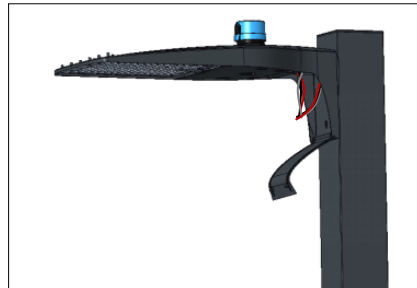

5. Connect wires in the wiring cavity

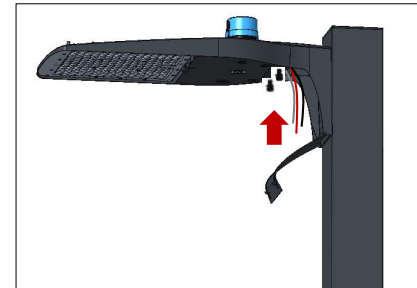

4. Lock the screw of light and mounting bracket